

Effective July 1, 2021 each county auditor in Washington State is required to print and distribute a local voters' pamphlet prior to every special, primary and general election.
(RCW 29A.32.210)

Whitman County

Official Local Voters' Pamphlet

Special Election

Tuesday, February 14, 2023

When returning your ballot, remember to:

- Postmark by Election Day or
- Deposit in an Official Ballot Drop Box by 8:00 pm on Election Day



Ballots are Mailed out on Jan. 27.

If you haven't received your ballot by Feb. 3, contact the Elections Office.

Register to vote or change your address until 8:00 pm on Election Day by coming into the Whitman County Elections Office.

(See page 2 for more information)



Whitman County Elections Office - Contact Information

In Person: 304 N. Main Street, Colfax

Phone: (509) 397-5284

Fax: (509) 397-5281

Email: elections@co.whitman.wa.us

Hours: Monday - Friday, 8:00 am - 4:30 pm*

*Open until 8:00 pm on February 14, Election Day

Web: www.whitmancounty.org/169/election-information

Although your ballot came with a prepaid postage return envelope this election, you can save taxpayer dollars by dropping off your ballot in one of the Ballot Boxes which are open 18 days prior to Election Day.

All Drop boxes will close at 8:00 pm on Election Day

Drop Box locations:

- Whitman County Elections Office, 304 N. Main St., Colfax, WA 99111
- Alley behind Elections Office, 304 N. Main St., Colfax, WA 99111

Voting Machines for the visually, hearing, or physically impaired are available at the Elections Office in Colfax (304 N. Main St.) 18 days prior to and on election day.

If you need a replacement ballot or have any questions, please contact the Whitman County Elections Department at (509) 397-5284, or email us at elections@co.whitman.wa.us





Participating Jurisdictions

The following jurisdictions have a resolution included in this pamphlet:

Colton School District No. 306

Oakesdale School District No. 324



Jurisdictions Waivered out of this pamphlet due to financial hardship

Lamont School District No. 264



Voting in Washington State

To Register to Vote, You Must:

- Be a citizen of the United States;
- Have lived at this address in Washington for at least 30-days immediately before the next election at which I vote;
- Be at least 16 years old by Election Day;
- Not be disqualified from voting due to a court order; and
- Not be under Department of Corrections supervision for a Washington State felony conviction; and
- I am not currently incarcerated for a federal or out-of-state felony conviction

How to Register to Vote or Change Your Address in Time for this Election:



Go to MyVote.wa.gov on or before February 6 if you have a current Washington State driver's license or I.D. card.



Complete and return a Washington State Voter Registration Form. Forms must be received in the Auditor's Office by February 14. Registration forms



Voting Instructions

1. The ballot packet will be mailed to you and will include your official ballot, a security sleeve, and a postage-paid return envelope.



2. To vote the ballot, fill in the oval next to your choice with a blue or black pen. Vote for only one in each contest or measure.



3. Place your voted ballot into the security sleeve. *If you forget the security sleeve, your ballot will still be counted.*

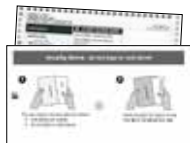

are online, or can be obtained by contacting the Whitman County Elections Office.



Come into the Whitman County Elections Office, by 8:00 pm on Election Day.

Registration Deadlines for the General Election:



Voter registration and address changes online or by mail **must be received by February 6.**

After February 6, visit our office to register to vote or change your address by 8:00 pm on Election Day.

Military or Overseas Voters:



Maintain your voter registration while in the military or living outside the United States. To register, use your home of record (or that of a family member). You may receive your ballot by mail, email, or fax. Contact us for more information.

4. Put the ballot/security sleeve into the return envelope and seal.



5. Sign and date your return envelope. **Your signature on the return envelope is required for your ballot to be counted.**

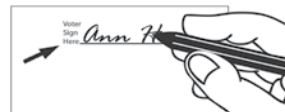

6. Return your ballot to the Whitman County Elections Office by ballot drop box or mail.



Or



Ballot must be in the drop box by 8:00 pm, February 14

Or

Ballot must be **postmarked** by February 14



Colton School District No. 306

Proposition No. 1

Replacement Educational Programs and Operation Levy

The Board of Directors of Colton School District No. 306 adopted Resolution No. 2211-37, concerning a proposition to finance educational programs and operation expenses. This proposition would authorize the District to levy the following excess taxes, in place of an expiring levy, on all taxable property within the District, for essential educational programs and operation expenses not funded by the State of Washington:

Collection Year	Assessed Value	Levy Amount
2024	\$2.26	\$398,497

all as provided in Resolution No. 2211-37. Should this proposition be approved?

Levy, Yes

Levy, No

Explanatory Statement

This proposition authorizes Colton School District to replace an existing educational programs and operation levy that will expire at the end of 2023. The proposed replacement levy will continue funding educational programs and operations that are not fully funded by the State, including teachers, support staff, athletics, CTE programing, extracurricular activities, nutrition, maintenance and operations, transportation and special education. Further information is available at <https://www.colton.k12.wa.us>. Taxes collected by the proposed replacement levy will provide approximately 11% of the District's General Fund budget. Exemptions from taxes may be available to certain homeowners, call Whitman County Assessor at (509) 397-6220.

Argument For

No Statement Submitted.

Argument Against

No Statement Submitted.



Oakesdale School District No. 324

Proposition No. 1

Replacement Educational Programs and Operation Levy

The Board of Directors of Oakesdale School District No. 324 adopted Resolution No. 02-2223, concerning a proposition to finance educational programs and operation expenses. This proposition would authorize the District to levy the following excess taxes, replacing an expiring levy, on all taxable property within the District, for educational programs and operation expenses not funded by the State:

	Estimated Levy Rate/\$1,000	
Collection Year	Assessed Value	Levy Amount
2024	\$3.68	\$667,000
2025	\$3.68	\$667,000
2026	\$3.68	\$667,000
2027	\$3.68	\$667,000

all as provided in Resolution No. 02-2223 and subject to legal limits on levy rates and amounts at the time of levy. Should this proposition be approved?

Levy, Yes

Levy, No

Explanatory Statement

The Oakesdale School District Educational Programs and Operation Levy is used to provide tuition free preschool, independent food services, curricular, co-curricular, and extracurricular activities, technology supplements, and elective courses.

Argument For

No Statement Submitted.

Argument Against

No Statement Submitted.